

Operating and Safety manual

Harbil HA180



© **Fast & Fluid Management B.V.**

This manual or parts thereof may not be reproduced, stored in a retrieval system, or transmitted, in any form or by any means, electronic, mechanical, photocopying, recording, nor otherwise, without the prior written permission of Fast & Fluid Management B.V.

This manual could contain technical inaccuracies or typographical errors.

Fast & Fluid Management B.V. reserves the right to revise this manual from time to time in the contents thereof without the obligation of Fast & Fluid Management B.V. to notify any person of such revision or change.

Details and values given in this manual are average values and have been compiled with care. They are not binding, however, and Fast & Fluid Management B.V. disclaims any liability for damage or detriments suffered as a result of reliance on the information given herein or the use of products, processes or equipment to which this manual refers. No warranty is made that the use of the information or of the products, processes or equipment to which this manual refers will not infringe any third party's patents or rights. The information given does not release the user from making their own experiments and tests.

Table of Contents

1	About this manual.....	5
1.1	How to work with the manual.....	5
1.2	Record of changes	5
2	Safety	6
2.1	Intended use.....	6
2.2	Liability.....	6
2.2.1	General liability	6
2.2.2	Machine-specific liability	6
2.3	User qualification for installation.....	7
2.4	CE certification	7
2.5	Safety symbols on the machine.....	8
2.6	Safety symbols in the manual.....	9
2.7	Disposal of the machine	9
3	Operator manual	10
3.1	Description.....	10
3.1.1	Overview of the machine (front) - manual can table version	10
3.1.2	Overview of the machine (front) - electrical can table version.....	11
3.1.3	Overview of the machine (back).....	12
3.1.4	Overview of the controls (manual can table version)	13
3.1.5	Overview of the controls (electrical can table version)	14
3.1.6	Overview of the display	15
3.1.7	Type plate: serial number	16
3.1.8	Type plate: details	16
3.2	Operation (manual can table version)	16
3.2.1	General dispensing procedure	17
3.2.2	Place the can.....	17
3.2.3	Move up the can table	17
3.2.4	Move down the can table	18
3.3	Operation (electrical can table version)	18
3.3.1	General dispensing procedure	18
3.3.2	Place the can.....	19
3.3.3	Move up the can table	19
3.3.4	Move down the can table	19
3.4	Maintenance	20
3.4.1	General cleaning: after every dispensing operation	20
3.4.2	Cleaning of the brush container: daily	20
3.4.3	Cleaning of the switch plate: monthly.....	23
3.4.4	Refilling of a canister	23
3.4.5	Using the emergency stop switch.....	24

4	Installation	26
4.1	Unpack the machine	26
4.1.1	Remove the cardboard	26
4.1.2	Remove the transport bracket of the turntable at the rear	26
4.1.3	Remove the wooden beams	26
4.1.4	Remove the transport brackets at the bottom	27
4.1.5	Remove the plastic protection on the canisters	27
4.1.6	Remove the plastic protection from the switchplate	27
4.2	Put the machine in position	28
4.2.1	Move the machine to the final location, with a ramp (optional)	28
4.3	Install the computer	29
4.3.1	Open the side cover	29
4.3.2	Install the computer	29
4.4	Turning on the machine	30
4.5	First use	30
5	Troubleshooting	31
5.1	General troubleshooting procedure	31
5.2	Audio signals	31
5.3	Error messages and other faults	32
5.4	Indicators on the display	33
5.5	Contact service	33
6	Technical data	34
6.1	General specifications	34
6.2	Dimensions and mass	34
6.3	Ambient conditions	34
6.4	Noise level	35
6.5	Safety classifications	35
6.6	Electrical specifications	35
6.7	Electrical diagram	36

1 About this manual

The manual shows the information necessary to:

- install
- operate
- perform basic maintenance
- correct small problems.

The HA180 and all its versions are referred to in the manual as the 'machine'.

This manual contains the original instructions. The original language of the manual is English. All other language versions are translations of the original instructions.

1.1 How to work with the manual

For the safe use of the machine, it is important:

- 1 To familiarize yourself with the structure and content.
- 2 To read the safety chapter in detail and make sure you understand all the instructions. See chapter § 2.
- 3 To carry out the actions completely and in the given sequence.

1.2 Record of changes

Edition	Editor	Check	Date	Description
1.0	EVT	TB	08/2019	First edition
2.0	EVT	TB	06/2020	General updates and addition of knock-out plate

2 Safety

**WARNING**

Read the manual before you install or use the machine. Failure to do so can result in personal injury, death or property damage.

2.1 Intended use

The machine is designed to dispense colorants into a can. Any other use of the machine is strictly forbidden.

2.2 Liability

2.2.1 General liability

Our machines and accessories are fully compliant with the CE regulations. Any modification can result in not fulfilling the CE safety requirements and is therefore not allowed. Fast & Fluid Management B.V. will not accept any responsibility in case of modifications to machines and/or accessories.

Fast & Fluid Management B.V. is not liable if you do not follow the rules below:

- The machine is for indoors use only.
- This machine may only be used for commercial settings. The machine is not a household appliance.
- Observe all local safety regulations.
- Strictly obey the safety instructions in this manual.
- Mind the minimal requirement of the building structure of the load capacity of the floor.
- Place the machine in a well-lit and well-ventilated room.
- Place the machine on a flat, horizontal floor.
- Install and connect the machine according to the instructions in this manual.
- Connect the machine to a grounded wall socket.
- Do not use extension cords or inadequately rated power cables.
- Make sure that the power cable is freely accessible.
- Do not place objects on top of the machine.
- Keep lids, panels, and covers closed and in place whenever possible.
- Do not use a damaged machine. When you have doubts, contact your supplier.
- Keep the machine in good condition.
 - Clean the machine at the intervals and when dirty.
 - Make sure that defective parts are immediately replaced.
- Remove spilled liquids immediately, and unplug the machine in case of large spillages (> 500mL).
- Replace parts only with original Fast & Fluid Management B.V. spare parts.

All maintenance beyond the scope of this manual must be carried out by a qualified service technician that Fast & Fluid Management B.V. has trained and certified.

2.2.2 Machine-specific liability

This machine is designed to dispense colorants into a can in non-hazardous conditions. In addition to following the instructions below, please consult with your paint supplier and/or colorant supplier, and review all applicable product information and safety data sheets to fully understand the risks associated with the use of their products, including how risks of fire and explosion may arise during use.

- Read and strictly comply with the safety data sheets for all colorants, (base) paint and brush liquids.

**WARNING**

The use of flammable colorants or colorants that diffuse potential explosive vapours may present fire and explosion risks. You are responsible for ensuring there is no build-up of explosive vapours both inside or around the dispenser.

**WARNING**

Do not use flammable liquids in the brush container.

**WARNING**

Risk of fire and personal injury if the temperature inside the dispenser when in use ("Operating Temperature") exceeds the flashpoint of the colorant or paint being used.

- You are responsible for ensuring that Operating Temperature never exceeds the flashpoint of the colorant in use, or, in the alternative, ensuring that there is no build-up of explosive vapors inside or around the dispenser.
- The Operating Temperature consists of the Ambient Temperature in the place of operation, plus an additional 15 °C / 27 °F generated by the dispenser when in use. The Ambient Temperature is determined by factors such as the temperature in the room or space where the dispenser is being operated, the amount of ventilation in and around the machine, or any other factors in your operating environment affecting temperature.
- In the event Operating Temperature exceeds the flashpoint of the colorant in use, you must take the following measures:
 - reduce the Operating Temperature by taking steps including but not limited to (a) operating the dispenser in a room or environment with a lower temperature; (b) increasing ventilation in and around the dispenser; and/or (c) taking any other steps to reduce the Ambient Temperature; and/or
 - select a different colorant or paint with a flashpoint higher than the likely Operating Temperature.
- An operational and environmental assessment is required before using flammable colorants in the dispenser, taking into account all local circumstances including ventilation around the machine, room and machine operating temperature and room size. Please consult your supplier for more details.
- The place of operation cannot be an ATEX zone or any kind of explosive atmosphere.
- In countries for which UL or CSA standards apply: this equipment cannot be used with colorants with a flashpoint below 38 °C / 100 °F.

2.3 User qualification for installation

Only install the machine when you are a qualified service technician who is trained and certified by Fast & Fluid Management B.V.

2.4 CE certification

The machine is CE certified. This means that the machine complies with the essential requirements concerning safety. The directives that have been taken into consideration in the design are available on www.fast-fluid.com.

2.5 Safety symbols on the machine



Rotating parts hazard



Pinch hazard for your hand



Read the manual



Electrical hazard



Pinch hazard for your foot



Can table switch up/down

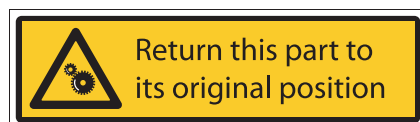

Return this part to its original position.



Do not use flammable liquids in the brush container.

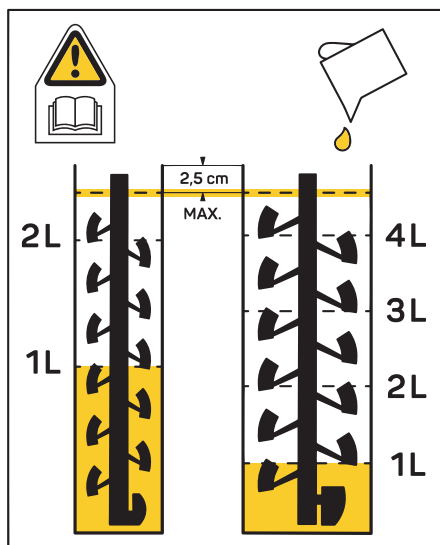

Refill the canisters.
Read the manual.

2.6 Safety symbols in the manual

**WARNING**

Can cause personal injury.

**WARNING**

Pinch hazard for your foot.

**CAUTION**

Can cause damage to the machine.

**Note**

Shows further information.

2.7 Disposal of the machine

1. Sort the machine, the accessories and the packaging for environmentally friendly recycling.
2. Do not dispose of the machine into domestic waste. Dispose of the machine according to local regulations.
3. Dispose of the canisters as chemical waste, according to the local regulations.



3 Operator manual

3.1 Description

3.1.1 Overview of the machine (front) - manual can table version

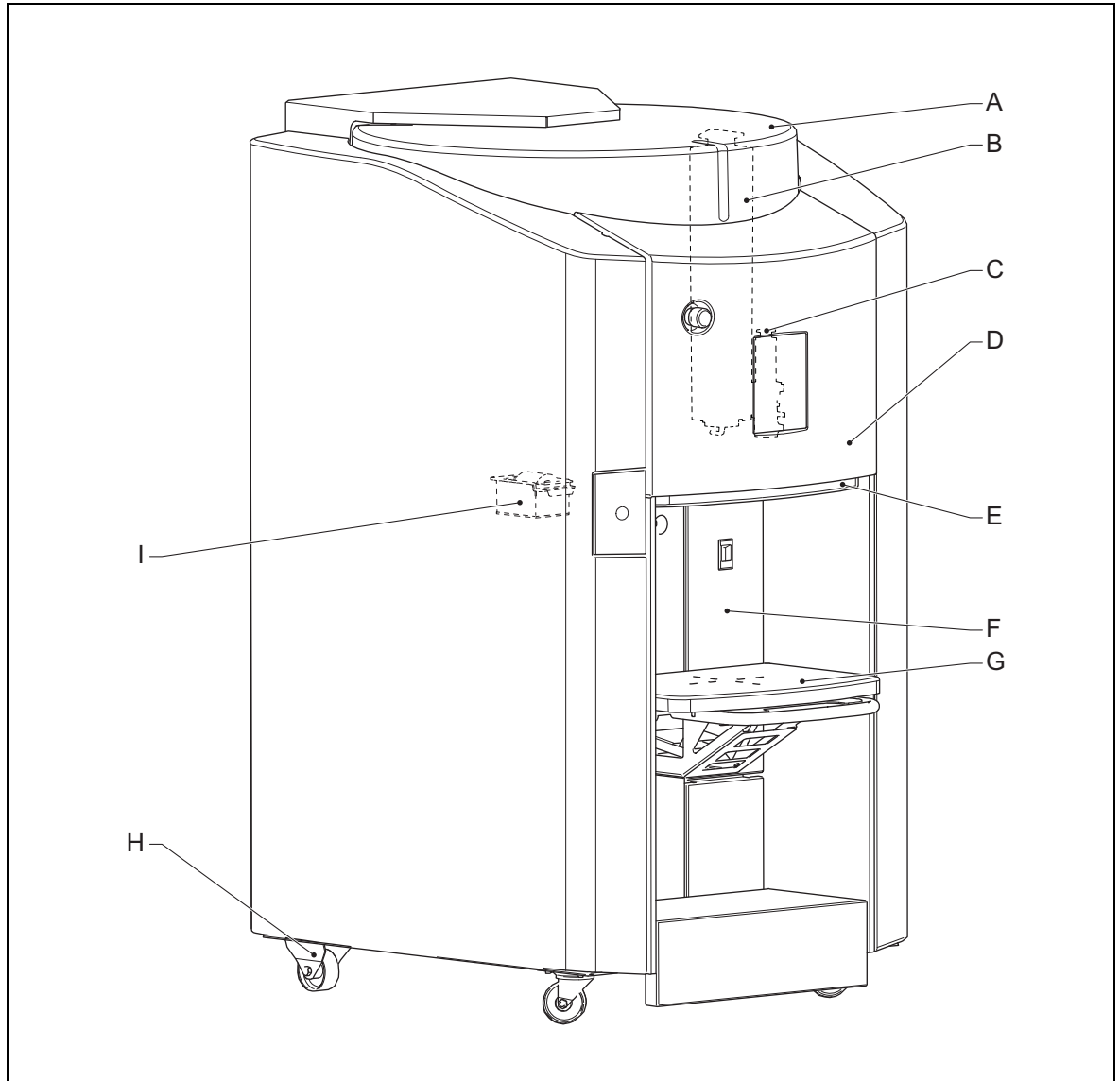

- A: Top cover
- B: Canister
- C: Pump with nozzle
- D: Front cover
- E: Switch plate

- F: Computer cover
- G: Can table
- H: Wheels
- I: Brush container

3.1.2 Overview of the machine (front) - electrical can table version

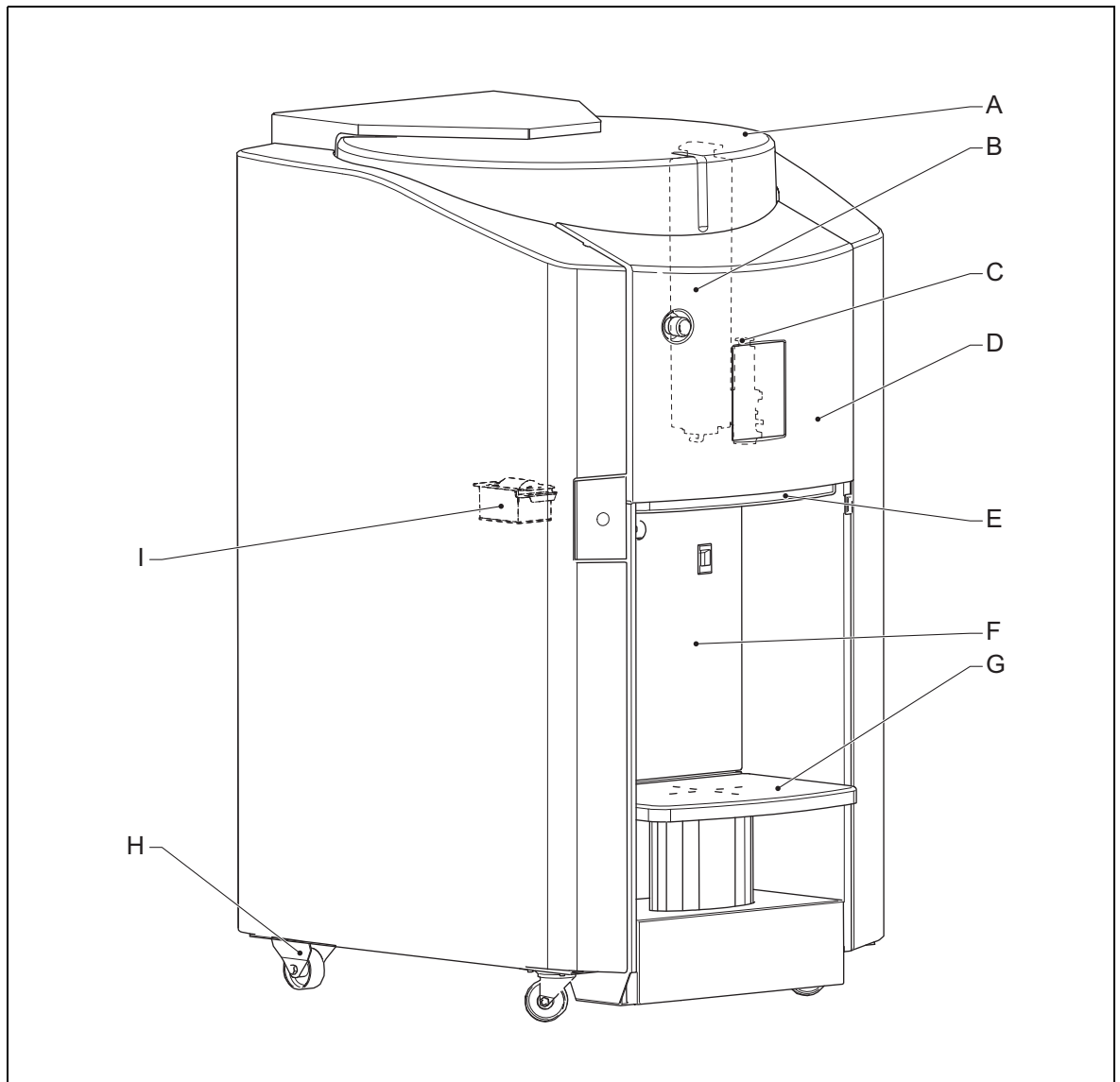

- A:** Top cover
B: Canister
C: Pump with nozzle
D: Front cover
E: Switch plate

- F:** Computer cover
G: Can table
H: Wheels
I: Brush container

3.1.3 Overview of the machine (back)

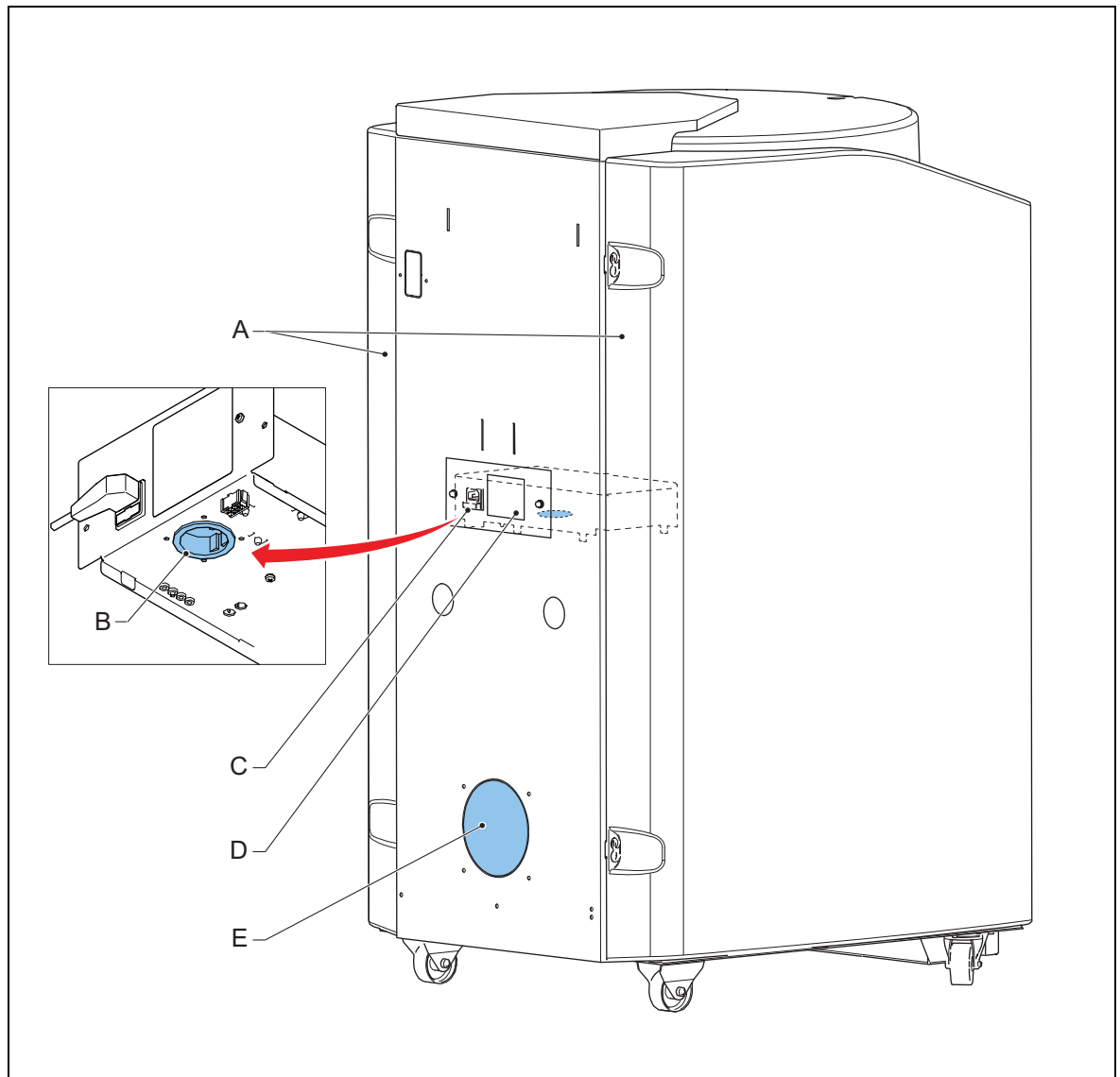

- A: Side cover
- B: Power socket
- C: Net entry
- D: Type plate
- E: Knock-out plate for ventilation interface

3.1.4 Overview of the controls (manual can table version)

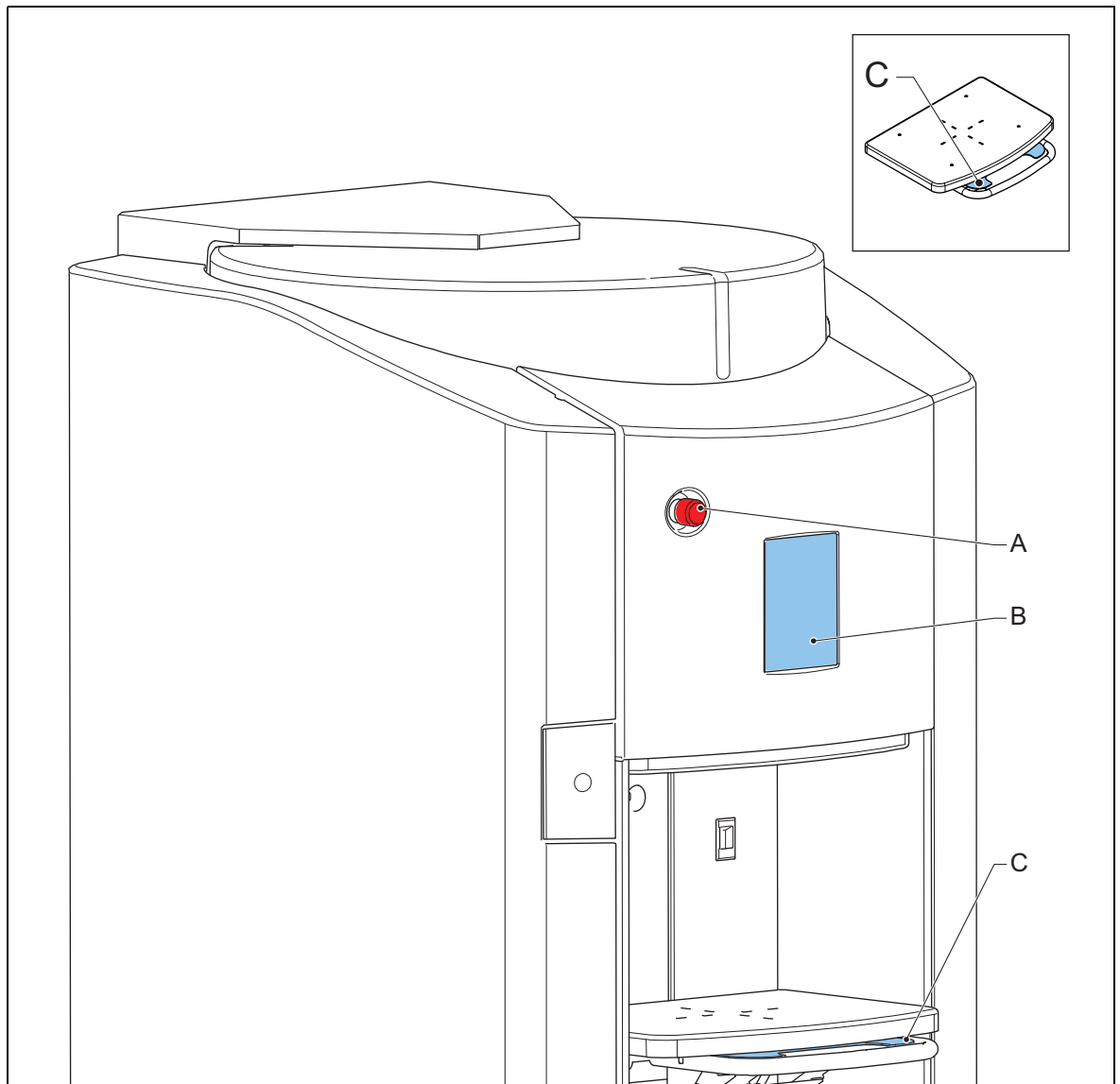

- A:** Emergency stop switch
B: Display with indicators and keys
C: Can table switch

3.1.5 Overview of the controls (electrical can table version)

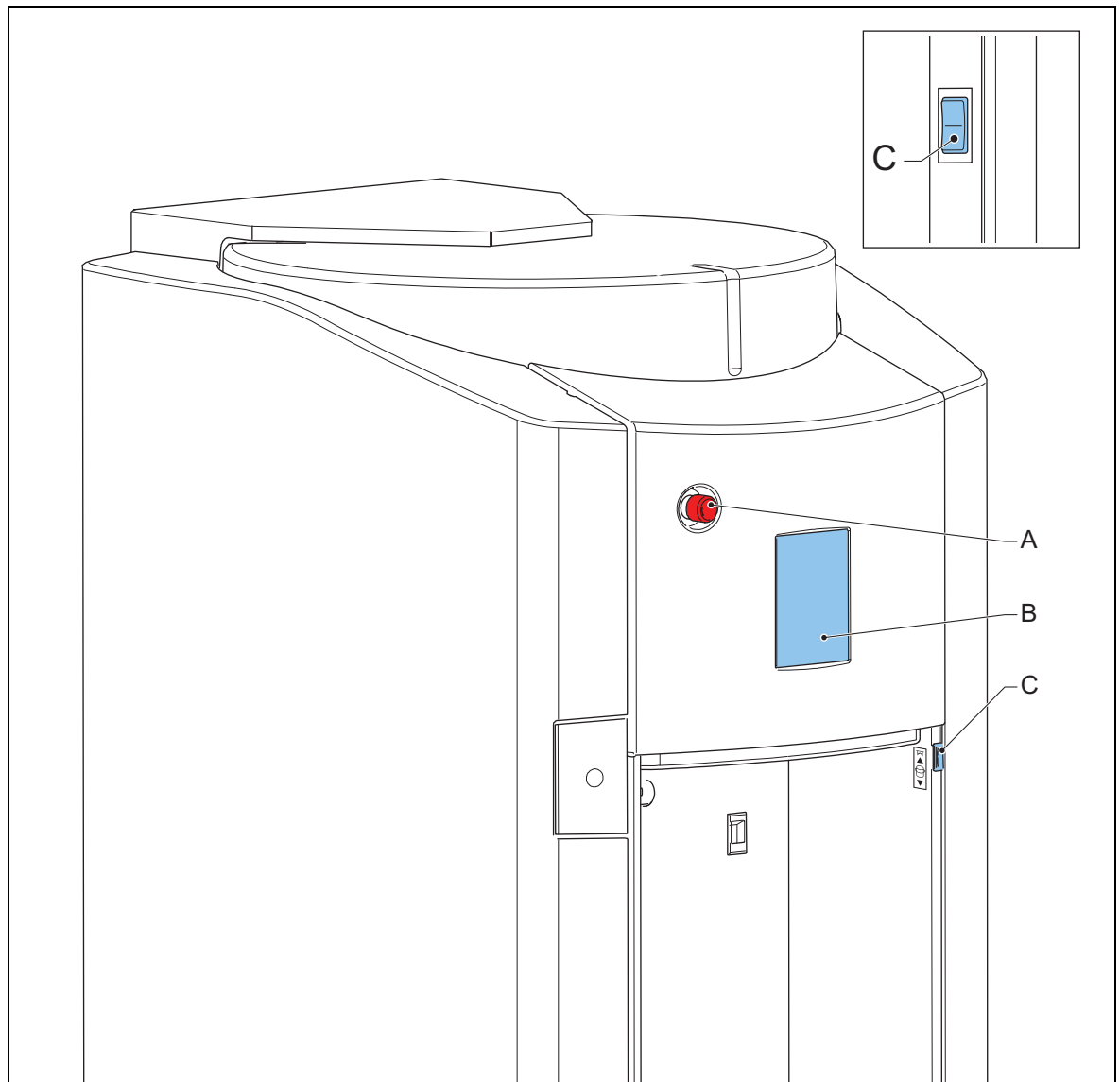

- A: Emergency stop switch
- B: Display with indicators and keys
- C: Can table switch

3.1.6 Overview of the display

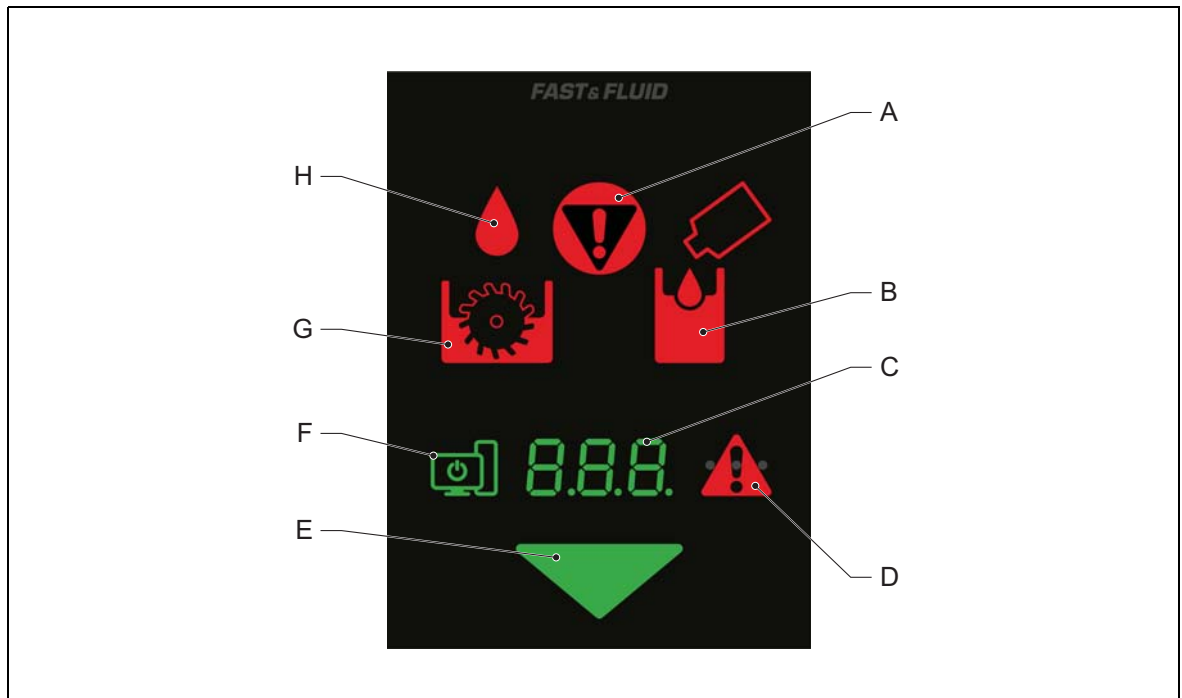

- A:** Emergency stop indicator
B: Canister refill indicator
C: Error / counter display
D: Error indicator and Error / function key
E: Can indicator
F: Computer switch key
G: Brush refill indicator
H: Brush monitor indicator

Item	Function
Indicator	When the indicator is on, it shows the status of the item or problem. See § 5.4 for possible causes and solutions.
Error / counter display	The display shows: <ul style="list-style-type: none"> - The error codes - The software version - The seconds that remain for the dispense operation See § 5.3 for a description of the error codes and the possible causes and solutions.
Error key	When you push the error key, the error display shows the program version. When you push the error key for more than 5 seconds, the machine will start/initialize.
Function key	When you push the function key, the counter display shows the software version.
Computer switch key	When you push the computer switch key, you will hear 'two beeps'; the button will flash. When you push and hold the computer switch key for 5 seconds, you will hear a beep again and the PC will shut down.
Can indicator	The can indicator shows the status of the can: <ul style="list-style-type: none"> - Flashing green: the dispense is done - Flashing red: the can is missing (the sensor does not see the can)

3.1.7 Type plate: serial number

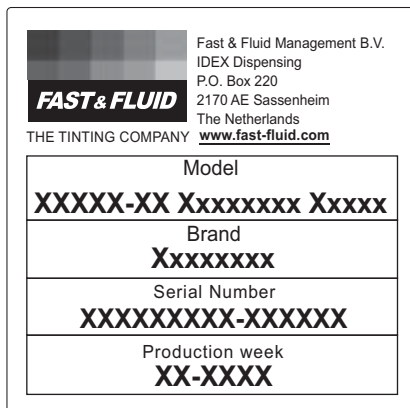

3.1.8 Type plate: details

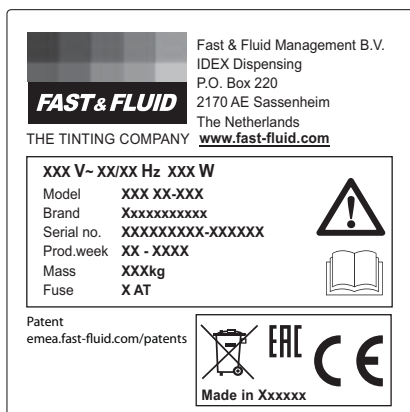

3.2 Operation (manual can table version)



WARNING

Only push the emergency stop switch in the case of a safety emergency.

Make sure that the problem is solved before you reset the emergency stop switch.

When you reset the emergency stop switch, the machine restarts automatically.



CAUTION

Do not remove the power from the machine. The machine must stir the colorants periodically.

**Note**

The computer switch only turns the computer on and off.

3.2.1 General dispensing procedure

For all the software instructions: see the software documentation.

1. Place the can. See § 3.2.2.
2. Move the can table up. See § 3.2.3.
3. Choose the recipe and dispense. See the software documentation.
4. Move the can table down. See § 3.2.4.
5. Remove the can.

3.2.2 Place the can

1. Place the can (A) at the centre of the mark (B) on the can table.

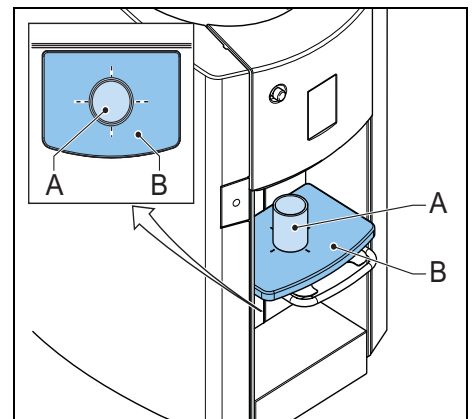
**3.2.3 Move up the can table**

1. Hold the handle (C) and push down the can table switch (A). Keep the can table switch pushed down.
2. Manually move up the can table (B).
3. Release the can table switch. *The can table locks into position.*

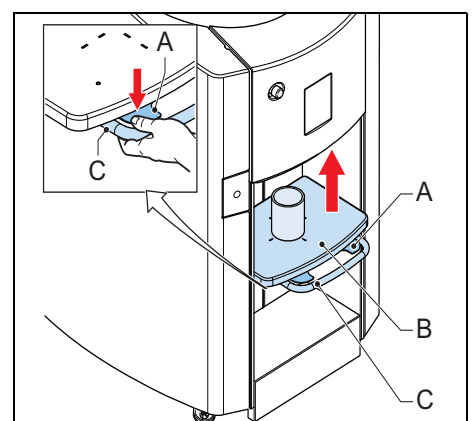

3.2.4 Move down the can table

1. Hold the handle (C) and push down the can table switch (A). Keep the can table pushed down.
2. Manually move down the can table (B).
3. Release the can table switch. *The can table locks into position.*

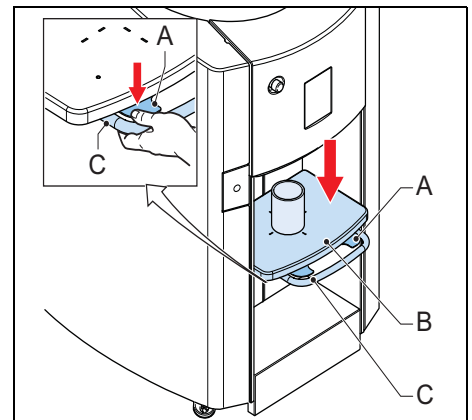

3.3 Operation (electrical can table version)



WARNING

Only push the emergency stop switch in the case of a safety emergency.

Make sure that the problem is solved before you reset the emergency stop switch.

When you reset the emergency stop switch, the machine restarts automatically.



CAUTION

Do not remove the power from the machine. The machine must stir the colorants periodically.



Note

The computer switch only turns the computer on and off.

3.3.1 General dispensing procedure

For all the software instructions: see the software documentation.

1. Place the can. See § 3.3.2.
2. Move the can table up. See § 3.3.3.
3. Choose the recipe and dispense. See the software documentation.
4. Move the can table down. See § 3.3.4.
5. Remove the can.

3.3.2 Place the can

1. Place the can (A) at the centre of the mark (B) on the can table.

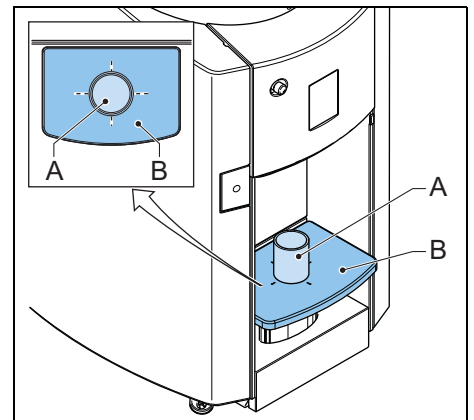

3.3.3 Move up the can table

1. Push and hold the upper part of the can table switch (A). *The can table (B) moves up and stops when the can is in front of the can sensor (C).*
2. After the can table stops, release the can table switch.

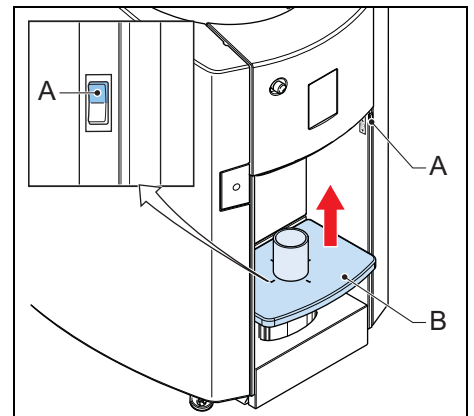

3.3.4 Move down the can table

1. Push and hold the lower part of the can table switch (A). *The can table (B) moves down.*

**WARNING**

Do not put your foot below the can table.

2. When you can remove the can, release the can table switch. If you hold the can table switch, the can table moves down to a halt.

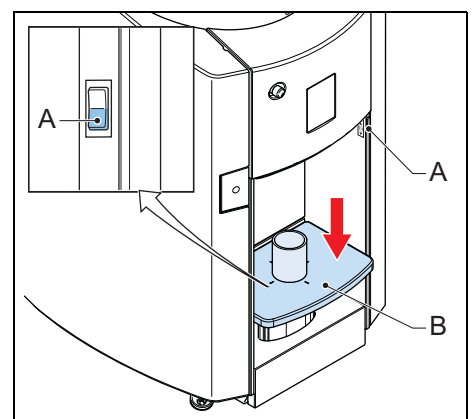

3.4 Maintenance

3.4.1 General cleaning: after every dispensing operation

1. Clean the machine with a cloth and remove all spilled colorant or other liquid.

**CAUTION**

Do not use cleaning agents based on organic solvents to clean painted or plastic parts of the machine.

3.4.2 Cleaning of the brush container: daily

**CAUTION**

If you do not clean these items daily, severe pollution will occur.

Open the brush drawer

1. Push the front side of the brush drawer until the brush drawer is unlocked.
2. Open the brush drawer (A). Use the handle (B).

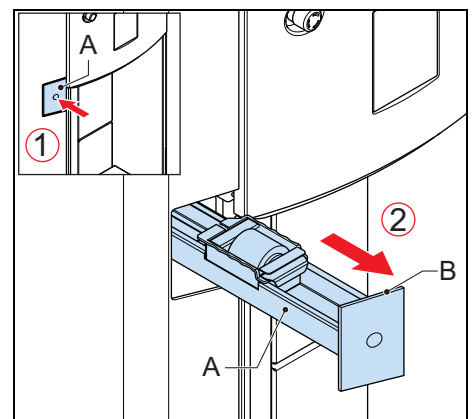
**Remove the brush container**

1. Remove the brush container (A) from the brush drawer (B).

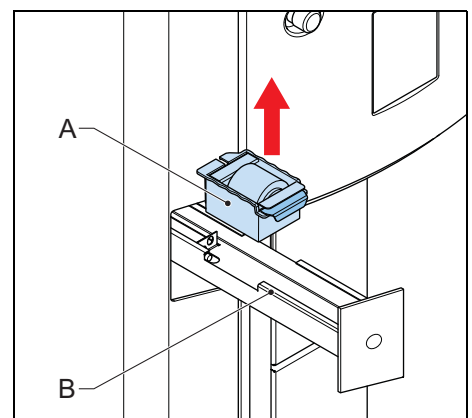

Remove the brush

1. Remove the brush from the brush container.

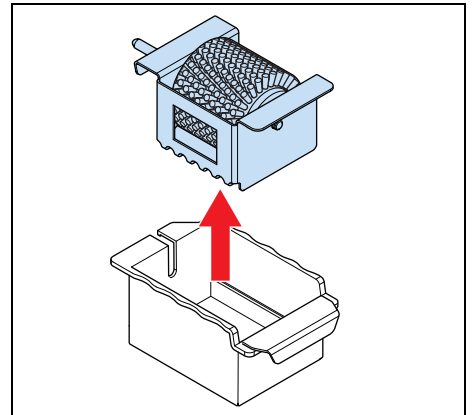
**Clean the brush container**

1. Remove the liquid from the brush container. For the disposal of the liquid, follow the local regulations.

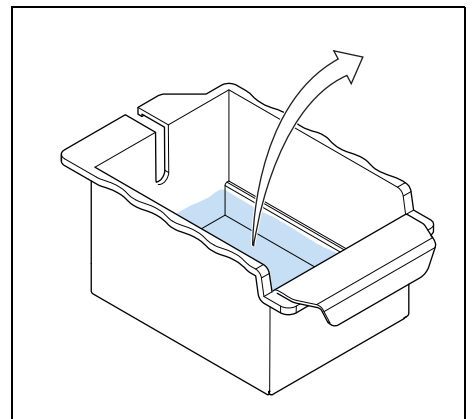
**Fill the brush container**

1. Fill the brush container with the liquid that your paint supplier indicates. The level of the liquid must be between the "MIN" and "MAX" mark.

**WARNING**

Do not put flammable liquids in the brush container.

**Note**

When the "MIN"/"MAX" mark is not visible, fill the brush container until the brush rotates through the liquid.

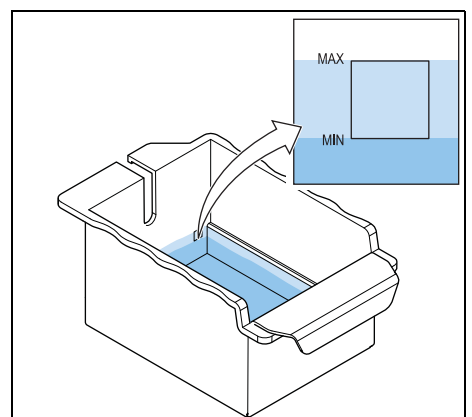

Put back the brush

1. Put back the brush into the brush container.

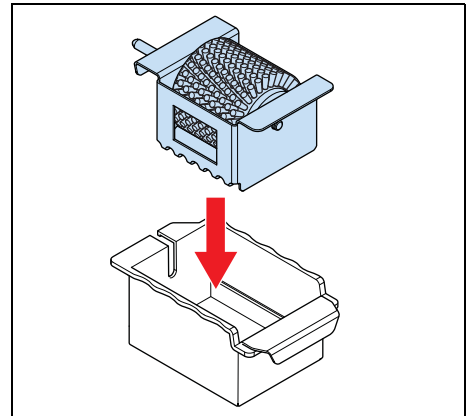
**Put back the brush container**

1. Put back the brush container (A) in the brush drawer (B).

**Note**

Make sure that the brush container is correctly put in its position, otherwise the machine does not function properly.

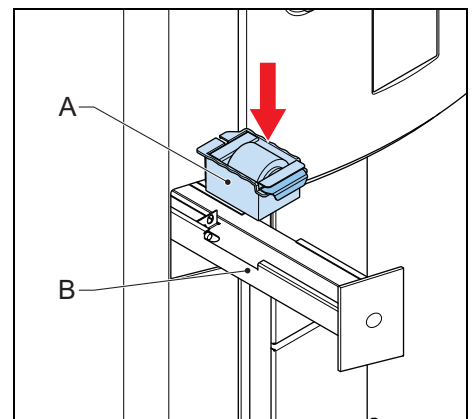
**Close the brush drawer**

1. Push the brush drawer (A) in the machine until the brush drawer is locked.

**Note**

When you release the brush drawer, the brush drawer moves slightly forward into place.

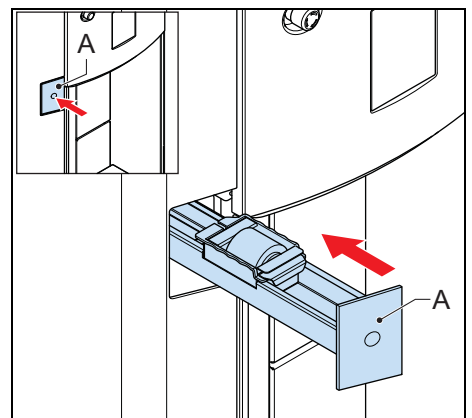

3.4.3 Cleaning of the switch plate: monthly

Remove the switch plate

1. Remove the switch plate (A).
 - a. Push the switch plate upward and then forward. *This way the hooks (B) are disconnected from the machine.*
 - b. Lower the switch plate.
 - c. Pull out the switch plate.

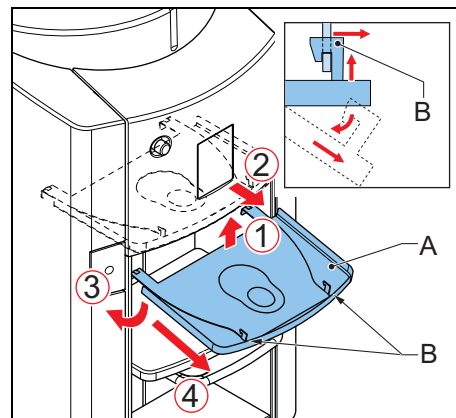

Clean the switch plate

1. Clean the switch plate. *Use a cleaning cloth with a non-organic cleaning liquid.*

Put back the switch plate

1. Put back the switch plate (A).
 - a. Slide in the switch plate at the back and lift it upward.
 - b. Make sure that the hooks (B) are connected to the machine.
 - c. Slide in the switch plate forward until it is locked to the machine.

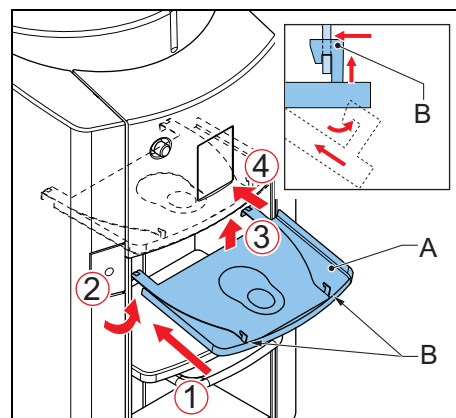

3.4.4 Refilling of a canister



WARNING

Check the material safety data sheet (MSDS) of the colorants for the personal protection measures that are required for handling the colorant.



CAUTION

Make sure that the colorant level in the canister is correct. If a canister is empty, this can cause an inaccurate dispensing and/or a recipe fault.

**Note**

The software checks the level of colorant in each canister. The software on the machine shows when you need to refill a canister.

1. In the software, activate the fill canister option.
2. Open the top cover (A).
3. Remove the lid of the canister (B).
4. Add the colorant (C). Do not spill.

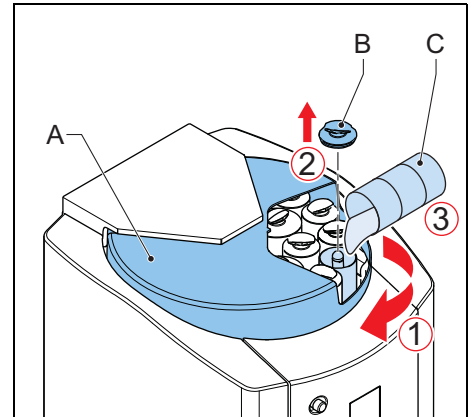

5. Put back the lid of the canister.
6. Close the top cover.

**Note**

Make sure that the top cover is closed correctly. The groove must be in the front center.

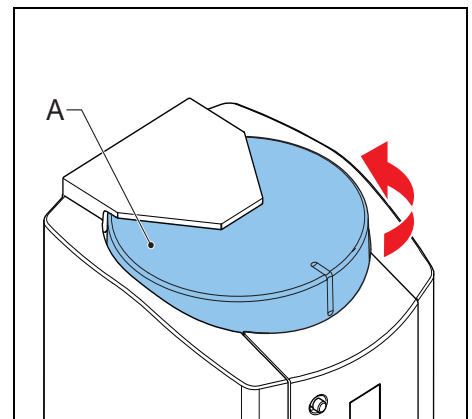

3.4.5 Using the emergency stop switch

1. Push the emergency stop switch (A). The machine stops immediately.

**CAUTION**

Only push the emergency stop switch in the case of a safety emergency. Do not use the emergency stop switch as an on/off function!

**Note**

The machine stays energized to keep the display in operation.

2. Solve the problem as quickly as possible.

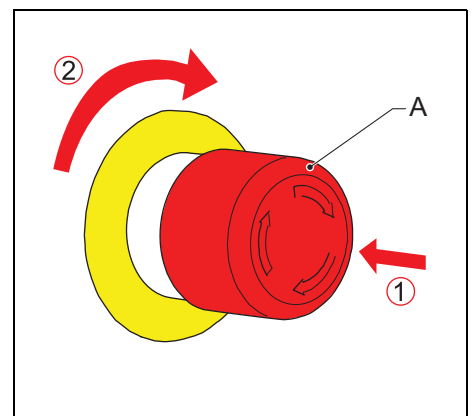

**CAUTION**

When the machine is shut down, the stirring mechanism, which is necessary to keep the colorant in optimal condition, is also shut down.

3. Reset the emergency stop switch by turning the emergency stop switch. The machine restarts automatically.

**Note**

After the reset of the emergency stop switch, the machine is operational.

4 Installation

4.1 Unpack the machine

4.1.1 Remove the cardboard

1. Remove the cardboard (A) and the plastic from the outside of the machine.

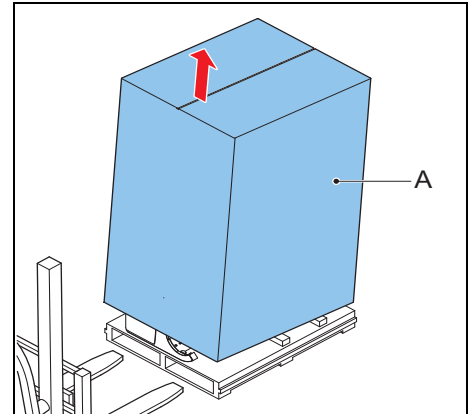

4.1.2 Remove the transport bracket of the turntable at the rear

1. Remove the fasteners.
2. Remove the transport bracket (A).

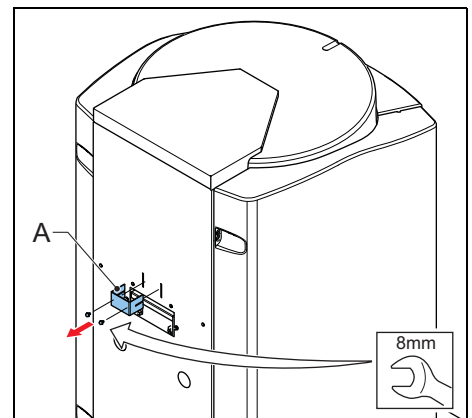

4.1.3 Remove the wooden beams

1. Remove the fasteners (A).
2. Remove the wooden beams (B).

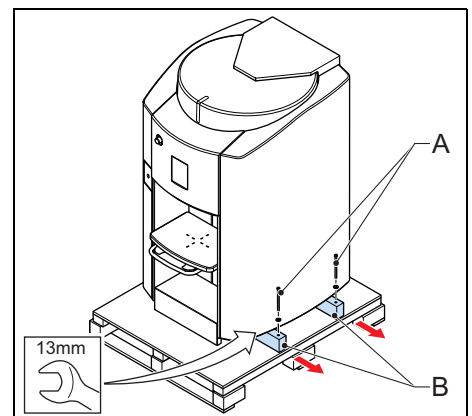

4.1.4 Remove the transport brackets at the bottom

1. Remove the transport brackets (A).

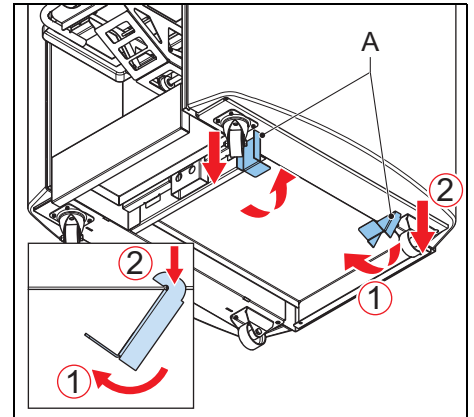
**4.1.5 Remove the plastic protection on the canisters**

1. Open the top cover. See § 3.4.4.
2. Remove the cardboard sheet (A) and the protective foam (B).
3. Close the top cover. See § 3.4.4.

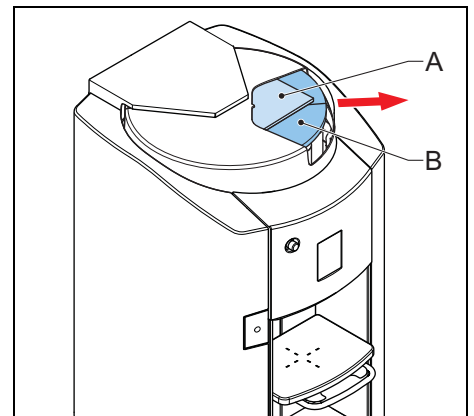
**4.1.6 Remove the plastic protection from the switchplate**

1. Remove the switchplate. See § 3.4.3.
2. Remove the plastic protection from the switchplate.
3. Put back the switchplate. See § 3.4.3.

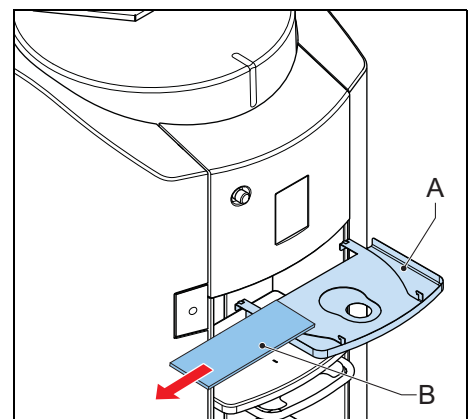

4.2 Put the machine in position

4.2.1 Move the machine to the final location, with a ramp (optional)

**WARNING**

Mind the minimum requirement of the load capacity of the floor. See § 6.2.

**WARNING**

Do not use a forklift.

**Note**

Make sure that the final location is well-lit and well-ventilated.

Make sure that the surface of the floor is horizontal.

1. Optionally, place the ramp (A).
2. Move the machine from the pallet on to the ground.
3. Move the machine to the final location.
4. Connect the power cable to the net entry.

**CAUTION**

Do not connect the power cable to the wall socket.

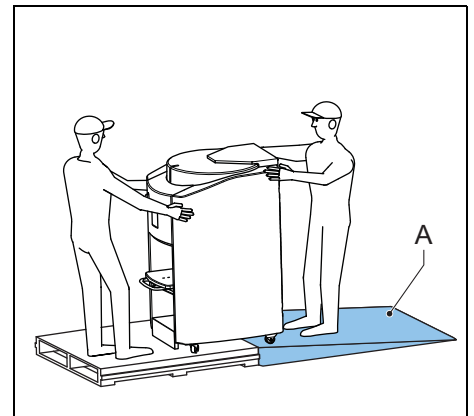

4.3 Install the computer

4.3.1 Open the side cover

1. Remove the fasteners (A).

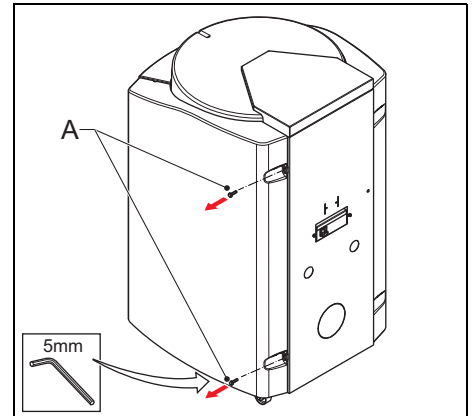

2. Remove the side cover (A).

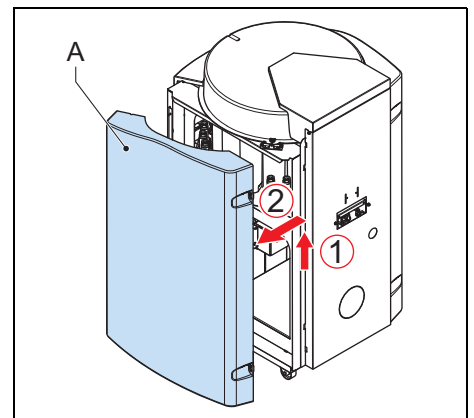

4.3.2 Install the computer



Note

Usually, the computer already has the correct software and drivers installed. If not, see the instructions in the installation manuals of your software provider.

1. Put the computer (A) in the machine.
2. Connect the power cable of the computer to the power socket.

**WARNING**

The maximum output of the socket is 1000 W.

3. Connect an USB cable between the computer and the power board.
4. Connect the keyboard, the mouse and the screen to the computer.

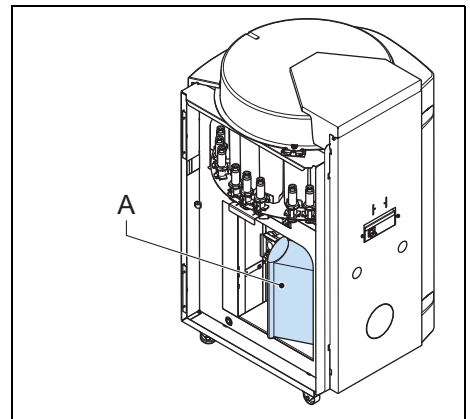

4.4 Turning on the machine

1. Connect the power cable to the wall socket.
2. Make sure that the emergency stop switch is reset.
See § 3.4.5.
3. Set the computer switch to 'ON'. *On the display, push the computer switch key. You will hear 'two beeps' and then the machine will initialize.*

4.5 First use

1. Fill the brush container. See § 3.4.2.
2. Fill the canisters. See § 3.4.4.
3. Flush the pumps. Use the flush command in the software.
See the software documentation.

5 Troubleshooting

5.1 General troubleshooting procedure

1. Try to solve the problem with the information in this manual.
See § 5.2 and § 5.3.
2. If it is not possible to solve the problem with the information in this manual, contact service. See § 5.5.

5.2 Audio signals

Note

See the column *Possible solution* to solve the problem. When the problem persists, contact service. See § 5.5.

Audio signal	Possible cause	Possible solution
••• — — — ••• SOS signal during the stirring.	The agitation motor is malfunctioning, a cable is broken or the power board is malfunctioning.	Contact service. See § 5.5.
— — — — —> 1 long interrupted beep (continuously 1 sec. on, 1 sec off)	Stirring function cannot start because the top cover is open.	Close the top cover.
————> 1 long uninterrupted beep	An error occurred.	See § 5.3.
•• 2 short beeps	The machine initializes.	-
— — — — — Long interrupted beeps, flush sound	The machines starts its daily flush round	-
— — — — — Long interrupted beeps, cleaning sound	The machines starts its daily cleaning rounds	-
• • • • • Short interrupted beeps	Power supply fault occurs	Contact service. See § 5.5.

5.3 Error messages and other faults

Note

For all error messages on the computer: see the help topic in the dispense software.

Note

See the column *Possible solution* to solve the problem. When the problem persists, contact service. See § 5.5.

Error message / fault	Possible cause	Possible solution
Main power supply is present but the machine does not work.	The emergency stop switch is active.	Reset the emergency stop switch. See § 3.4.5.
	A fuse is broken.	Contact service. See § 5.5.
Turntable turns slowly.	The top cover is not fully closed.	Close the top cover.
Display shows E01	The machine is not initialized.	Push the computer switch key to restart the machine. See § 3.1.6
Display shows E13	A turntable timeout occurred.	Push the computer switch key to restart the machine. See § 3.1.6
Display shows E33	A valve timeout occurred.	Push the computer switch key to restart the machine. See § 3.1.6
Display shows E43	A pump timeout occurred.	Push the computer switch key to restart the machine. See § 3.1.6
Display shows E47	The pump is blocked by the turntable	Push the computer switch key to restart the machine. See § 3.1.6
Display shows E49	The can is missing during the dispense process.	Place the can. See § 3.2.2. Then start the process again.
Display shows E63	The switch plate is missing.	Put back the switch plate. See § 3.4.3
Display shows E84	The brush container is missing.	Put back the brush container. See § 3.4.2.
All other E - errors	-	Restart the machine.

5.4 Indicators on the display

Indication	Possible cause	Possible solution
The error indicator is on	See § 5.3.	See § 5.3.
Canister refill indicator is on	The canister is empty	Refill the canister. See § 3.4.4.
Can indicator blinks and is red	The can is missing.	Place the can. See § 3.2.2.
Can indicator blinks and is green	The dispense process is finished.	Remove the can.
Brush is missing indicator is on	The brush container is missing.	Put back the brush container. See § 3.4.2.
Emergency stop indicator is on	The emergency stop switch is active.	Reset the emergency stop switch. See § 3.4.5.
Brush refill indicator blinks and the brush monitor indicator is on	The brush needs to be cleaned.	Clean the brush and the brush container. See § 3.4.2.

5.5 Contact service

1. Find the type plate on the rear of the machine. See § 3.1.8.
2. Take a note of the model number and the serial number of the machine.
3. Contact your supplier or manufacturer.
See www.fast-fluid.com.

6 Technical data

6.1 General specifications

Parameter	Specification
Number of canisters (max.)	24
Dispensing	Sequential
Pump type	Harbil piston pump
Cleaning system	Automatic
Materials used are suitable for	Water-, universal- and solvent-based colorants
Canister sizes [L]	2.3 and 4.6
Pump capacity [mL]	40
Maximum can height [cm]	42
Can table dimensions [cm]	44 x 31

6.2 Dimensions and mass

Parameter	Specification
Dimensions, height x width x depth [cm]	140 x 81 x 94
Packed dimensions, height x width x depth [cm]	193 x 117 x 98
Mass incl. packaging [kg]	± 200
Mass filled machine [kg]	± 380
Required load capacity of the floor [kg]	1520

6.3 Ambient conditions



WARNING

Risk of fire and personal injury for failing to read and follow instructions in § 2.2.



Note

This machine must be used or stored within the ambient temperature, altitude, and humidity ranges listed in the table below.

Parameter	Specification
Temperature [°C], when in use ¹	+10 to +35
Temperature [°C], when not in use ¹⁾	-25 to +55
Altitude above sea level [m], operational	-10 to 2000
Altitude above sea level [m], out of operation	-10 to 12000
Maximum relative humidity [RH], without condensation [%]	90

1. As defined in § 2.2.2.

6.4 Noise level

Parameter	Specification
Maximum noise level [dB(A)]	< 65

6.5 Safety classifications

Parameter	Specification
IP (Ingress Protection) classification	32
EMC (ElectroMagnetic Compliancy) classification	Class B
Overvoltage category	Class II

6.6 Electrical specifications

Parameter	Specification
Dispenser power consumption, maximum [W]	500
PC socket, maximum [W]	1000
Maximum leakage current [mA]	3.5
Country specific net cables	European
Voltage [V]	110 / 230 ± 10%
Frequency [Hz]	50 / 60
Fuse specifications [A] slow	10

6.7 Electrical diagram

